

- ESD -
***ECONOMIC
SLIDING DOOR
42 SERIES***

| PROFILE NO. | PICTURE OF PROFILE | WEIGHT (KG/M) | | | PACKING IN BUNDLE (PCS) |
|-------------|---|---------------------|------------------|------------------|-------------------------|
| | | AREA PERIMETER (MM) | | | |
| | | D 1.00 MM | H 1.20 MM | J 1.30 MM | |
| ESD 4201 |  | 0.496 344.224 | 0.618 343.336 | 0.679 344.069 | 6 |
| ESD 4202 |  | 0.450 296.251 | 0.511 293.825 | 0.541 296.095 | 6 |
| ESD 4203 |  | 0.382 271.080 | 0.455 269.536 | 0.492 271.080 | 10 |
| ESD 4204 |  | 0.300 208.352 | 0.350 207.266 | 0.425 207.435 | 12 |
| ESD 4205 |  | 0.457 206.547 | 0.536 205.205 | 0.576 206.547 | 10 |
| ESD 4206 |  | 0.446 227.573 | 0.527 225.173 | 0.568 227.573 | 12 |
| ESD 4207 |  | 0.483 320.319 | 0.580 317.425 | 0.628 320.319 | 6 |
| ESD 4208 |  | 0.258 160.464 | 0.280 160.500 | 0.291 160.385 | 12 |
| ESD 4209 |  | 0.325 212.454 | 0.354 211.75 | 0.393 212.119 | 12 |
| ESD 4210 |  | 0.289 189.866 | 0.314 187.53 | 0.355 189.738 | 12 |
| ESD 4212 |  | 0.451 298.662 | 0.492 298.860 | - | 6 |
| ESD 4217 |  | 0.183 134.928 | - | - | 12 |
| ESD 4218 |  | 0.731 512.008 | - | - | 6 |

All Profiles are standard length 6.1 M for ESD Series except ESD 4203, ESD 4205, & ESD 4206, ESD 4220 which is 4.34M or 4.88M

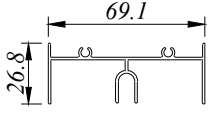
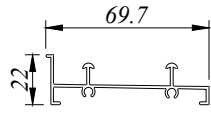
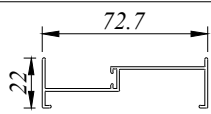
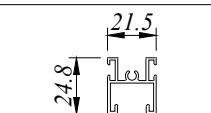
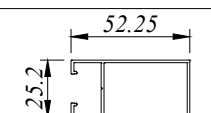
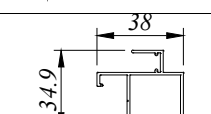
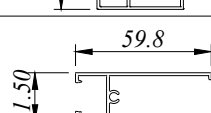
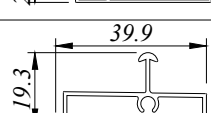
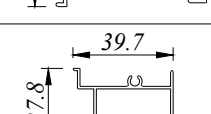
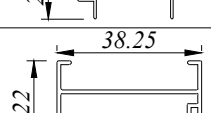
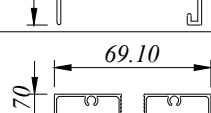
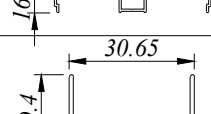
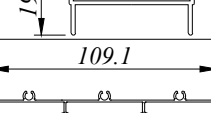
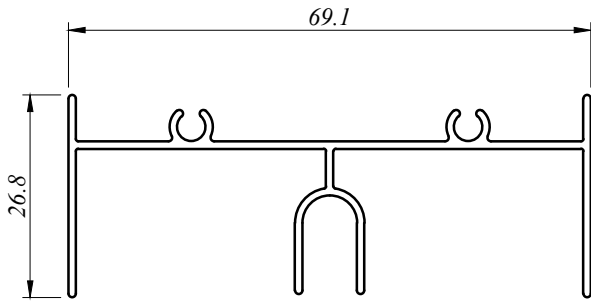

ESD 4201 D
0.496 Kg/M
AP : 344.224 MM

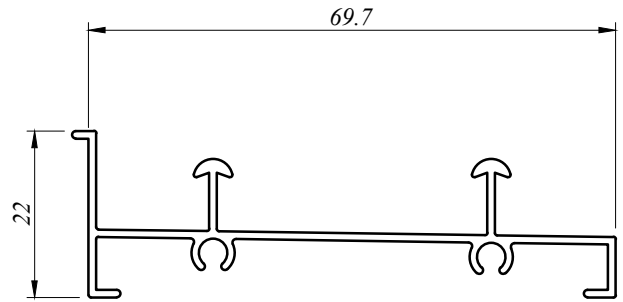

ESD 4202 D
0.450 Kg/M
AP : 296.100 MM

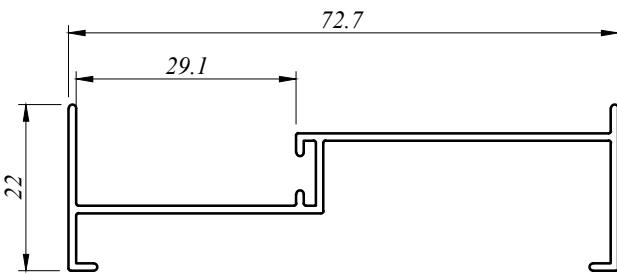

ESD 4203 D
0.382 Kg/M
AP : 271.080 MM

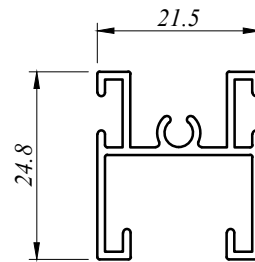

ESD 4204 D
0.300 Kg/M
AP : 208.352 MM

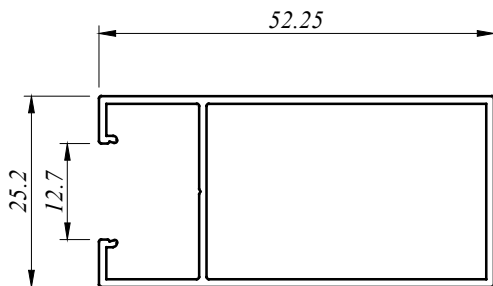

ESD 4205 D
0.457 Kg/M
AP : 206.547 MM

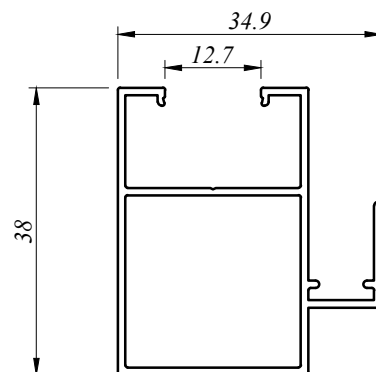

ESD 4206 D
0.446 Kg/M
AP : 227.573 MM

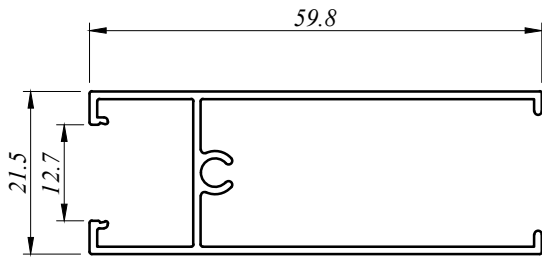

ESD 4207 D
0.483 Kg/M
AP : 320.319 MM

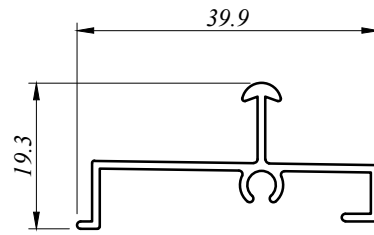

ESD 4208 D
0.258 Kg/M
AP : 160.464 MM

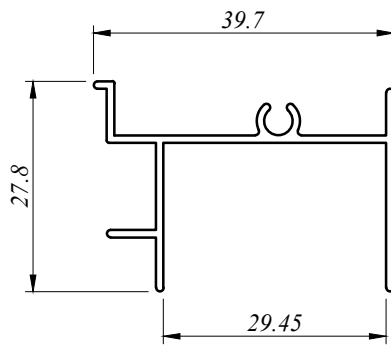

ESD 4209 D
0.325 Kg/M
AP : 212.454 MM

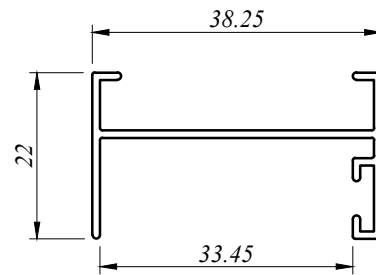

ESD 4210 D
0.289 Kg/M
AP : 189.866 MM

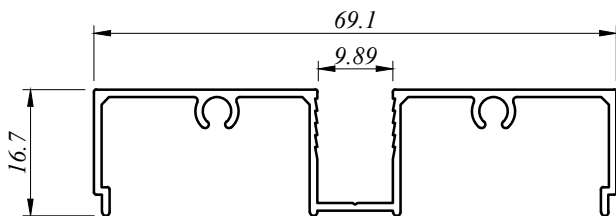

ESD 4212 D
0.451 Kg/M
AP : 298.662 MM

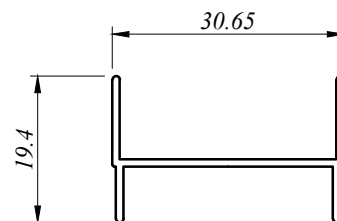

ESD 4217 D
0.183 Kg/M
AP : 134.926 MM

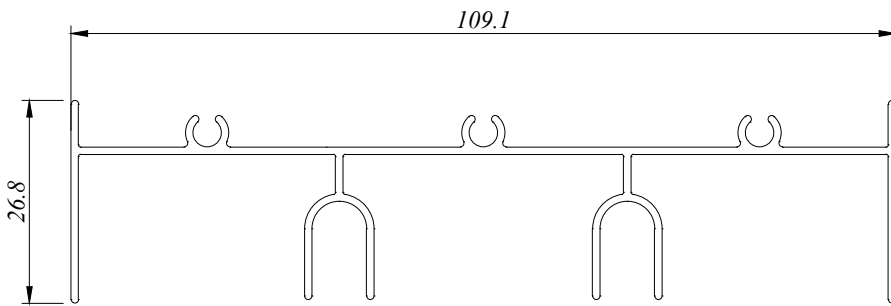

ESD 4218 D
0.731 Kg/M
AP : 512.008 MM

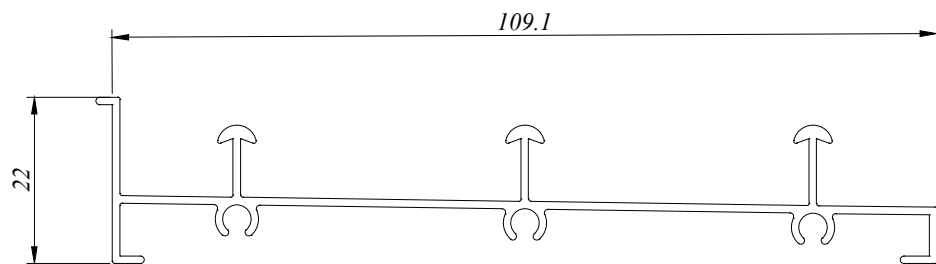

ESD 4219 D
0.620 Kg/M
AP : 418.816 MM

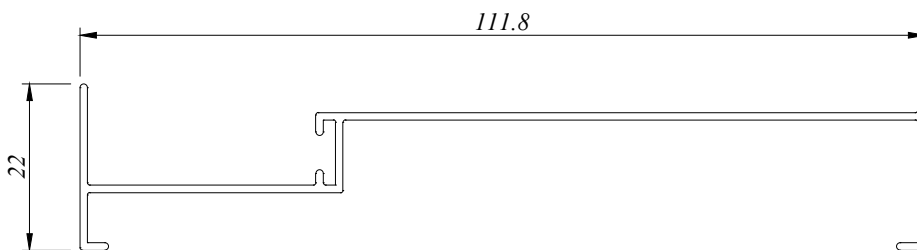

ESD 4220 D
0.489 Kg/M
AP : 349.280 MM

aluminium profiles component usage

Economic Sliding Door - ESD 42 Series

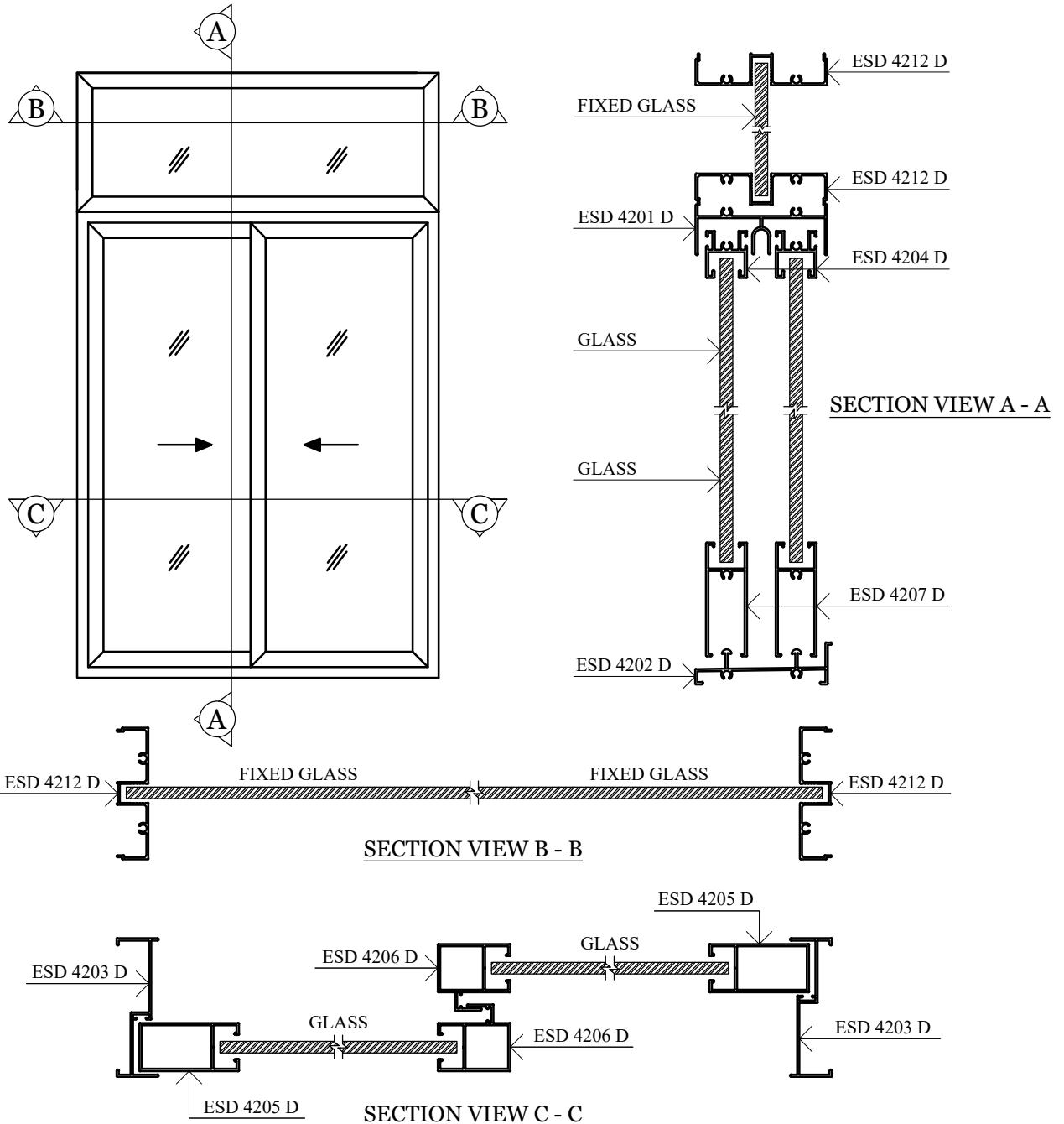

BP Aluminium Extrusion Sdn. Bhd.

No.15 & 16, 1C KKIP Selatan, Industrial Zone 2, KKIP,
88450, Jalan Sepanggar, Menggatal.



b_p_a_e@yahoo.com



www.bpaluminium.com