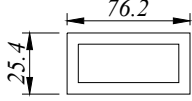
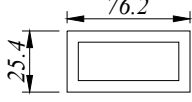
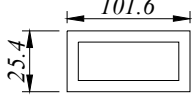
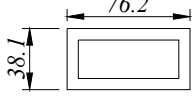
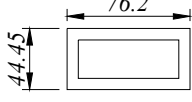
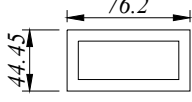
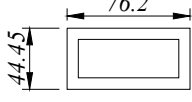
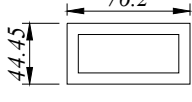
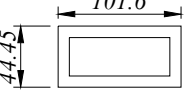
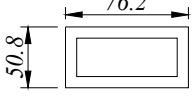
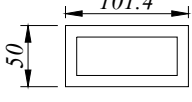
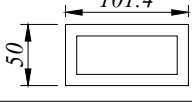

- RH -

***RECTANGULAR
HOLLOW
23 SERIES***

PROFILE NO.	PICTURE OF PROFILE	WEIGHT (KG/M)	THICKNESS	PACKING IN BUNDLE (PCS)
			AREA PERIMETER	
RH 23040810		0.196	1.00 MM 75.736 MM	20
RH 23040814		0.276	1.40 MM 75.736 MM	20
RH 23040816		0.303	1.60 MM 75.736 MM	20
RH 23061009		0.248	0.90 MM 101.085 MM	10
RH 23081208D		0.288	0.80 MM 126.485 MM	10
RH 23081210		0.334	1.00 MM 126.485 MM	10
RH 23081215		0.506	1.50 MM 126.485 MM	10
RH 23081608D		0.363	0.80 MM 151.885 MM	10
RH 23081609		0.374	0.90 MM 152.400 MM	10
RH 23081610		0.402	1.00 MM 151.885 MM	10
RH 23081612		0.480	1.20 MM 151.885 MM	10
RH 23082010		0.471	1.00 MM 177.800 MM	5
RH 23082409D		0.525	0.90 MM 202.685 MM	5

All Profiles are standard length 6.1 M for RH Series

PROFILE NO.	PICTURE OF PROFILE	WEIGHT (KG/M)	THICKNESS	PACKING IN BUNDLE (PCS)
			AREA PERIMETER	
RH 23082410		0.567	1.00 MM 203.200 MM	5
RH 23082412		0.675	1.20 MM 228.085 MM	5
RH 23083212		0.811	1.20 MM 253.485 MM	3
RH 23122412		0.728	1.20 MM 228.085 MM	3
RH 23142410		0.662	1.00 MM 240.785 MM	3
RH 23142411		0.730	1.10 MM 241.30 MM	3
RH 23142412		0.770	1.20 MM 241.300 MM	3
RH 23142420		1.302	2.0 MM 240.785 MM	3
RH 23143212		0.934	1.20 MM 290.885 MM	2
RH 23162411		0.766	1.10 MM 253.485 MM	2
RH 23163212		1.030	1.20 MM 302.800 MM	2
RH 23163225		2.043	2.50 MM 302.800 MM	2

All Profiles are standard length 6.1 M for RH Series

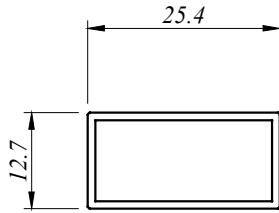

RH 23040810
0.196 Kg/M
AP : 75.736 MM

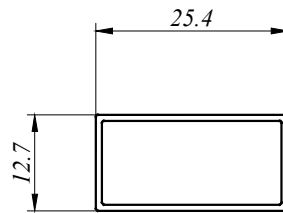

RH 23040814
0.276Kg/M
AP : 75.736 MM

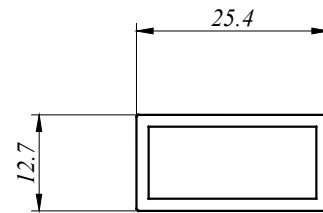

RH 23040816
0.303Kg/M
AP : 75.736 MM

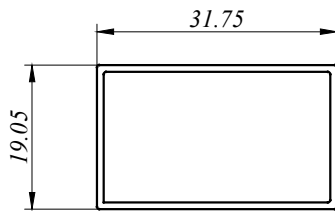

RH 23061009
0.248 Kg/M
AP : 101.085 MM

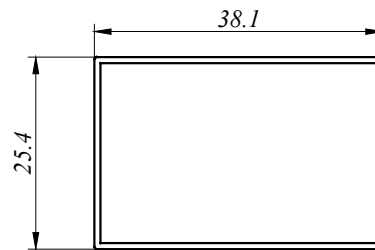

RH 23081208D
0.288 Kg/M
AP : 126.485 MM

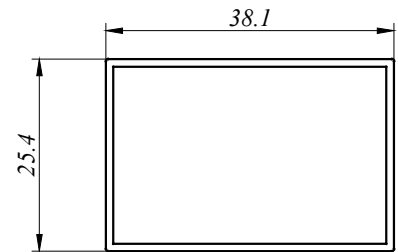

RH 23081210
0.334 Kg/M
AP : 126.485 MM

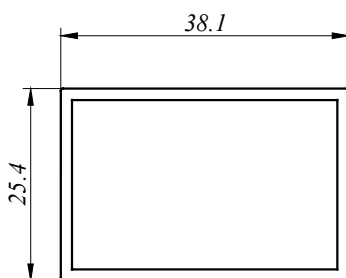

RH 23081215
0.506 Kg/M
AP : 126.485 MM

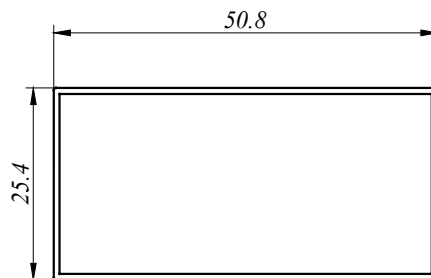

RH 23081608D
0.363 Kg/M
AP : 151.885 MM

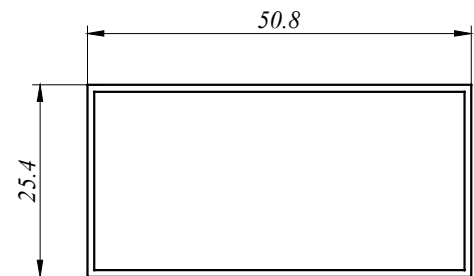

RH 23081609
0.374 Kg/M
AP : 152.400 MM

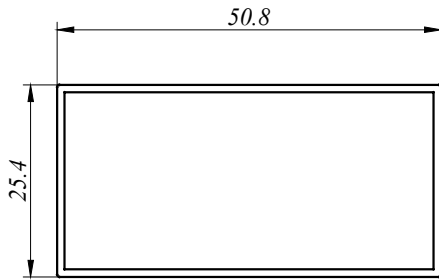

RH 23081610
0.402 Kg/M
AP : 151.885 MM

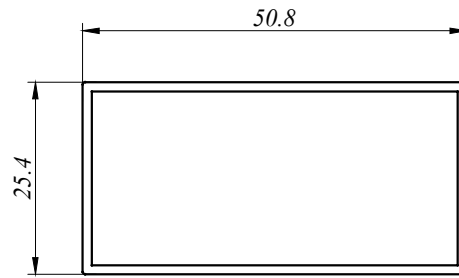

RH 23081612
0.480 Kg/M
AP : 151.885 MM

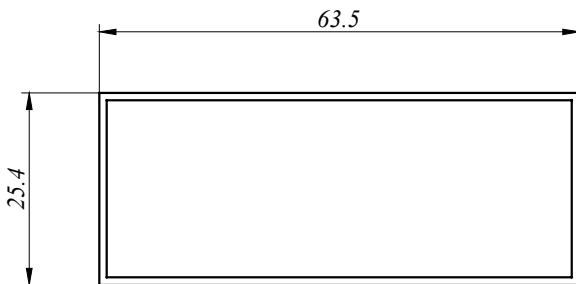

RH 23082010
0.471 Kg/M
AP : 177.800 MM

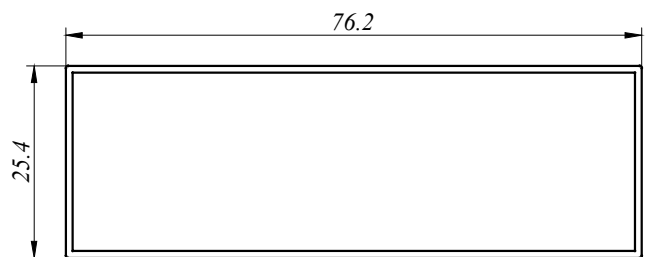

RH 23082409D
0.525 Kg/M
AP : 202.685 MM

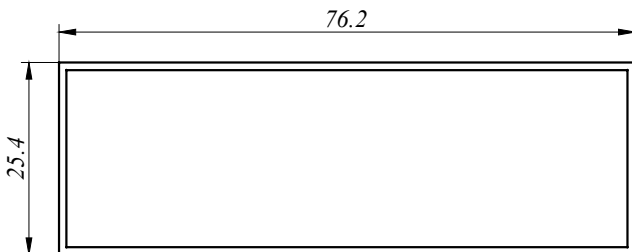

RH 23082410
0.567 Kg/M
AP : 203.200 MM

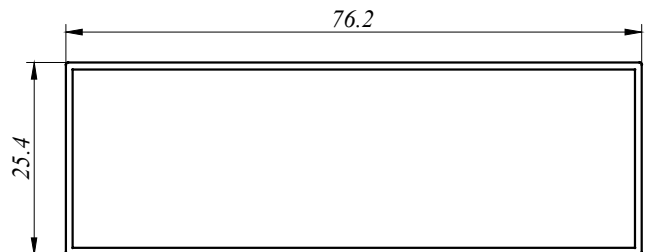

RH 23082412
0.675 Kg/M
AP : 228.085 MM

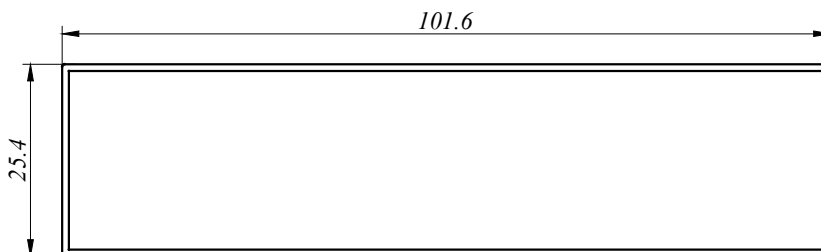

RH 23083212
0.811 Kg/M
AP : 253.485 MM

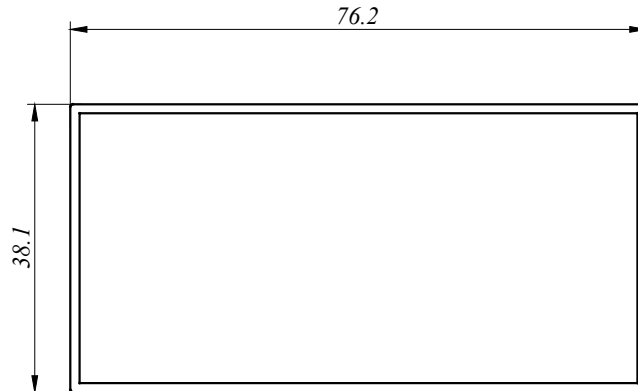

RH 23122412
0.728 Kg/M
AP : 228.085 MM

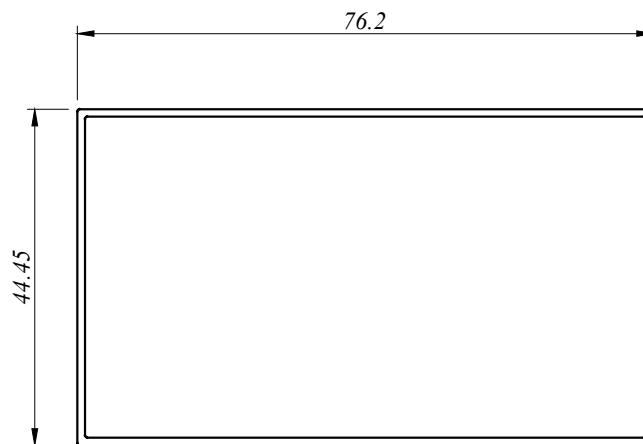

RH 23142410
0.662 Kg/M
AP : 240.785 MM

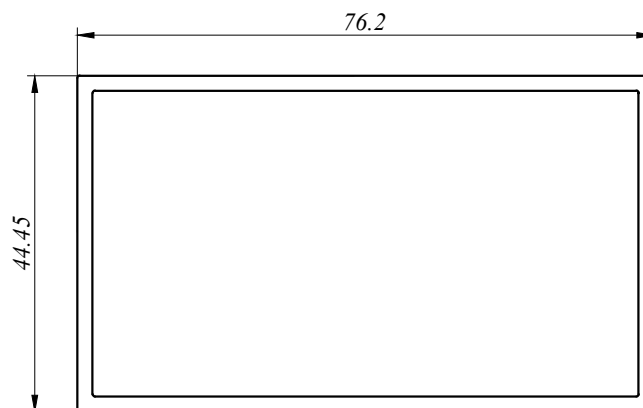

RH 23142420
1.302 Kg/M
AP : 240.785 MM

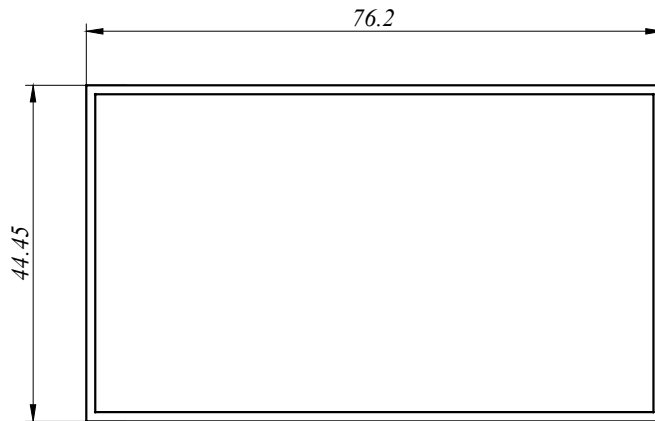

RH 23142412
0.770 Kg/M
AP : 241.300 MM

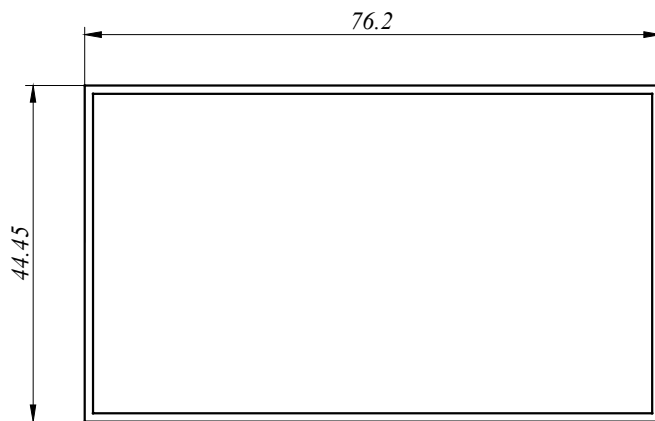

RH 23142411
0.730 Kg/M
AP : 241.30 MM

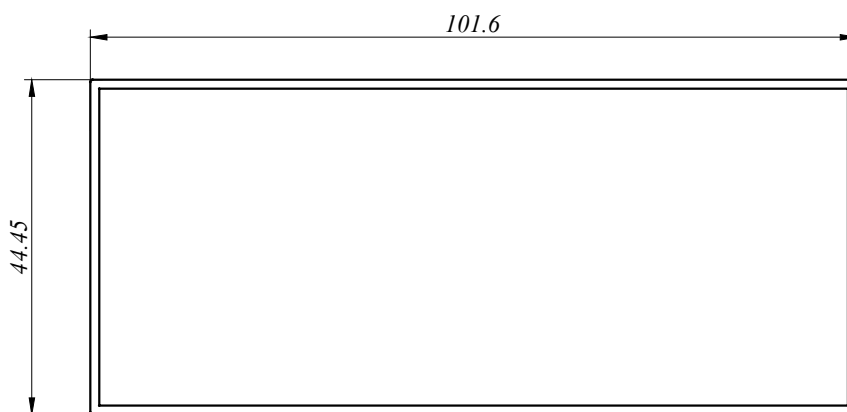

RH 23143212
0.934 Kg/M
AP : 290.885 MM

RH - Rectangular Hollow

23 SERIES

RH 23162411
0.766 Kg/M
AP : 253.485 MM

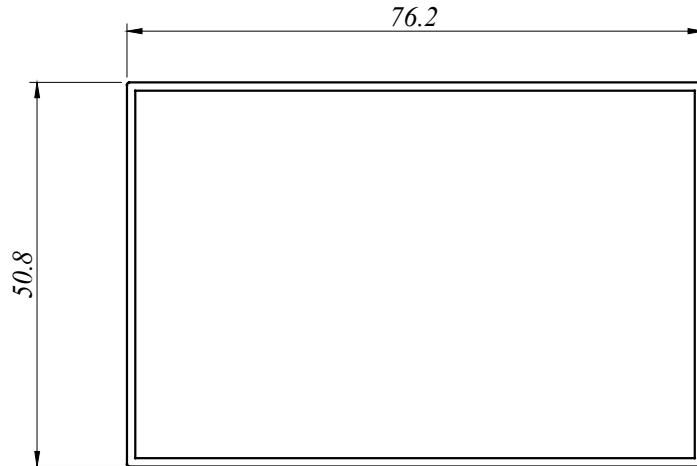

RH 23163213
1.080 Kg/M
AP : 302.800 MM

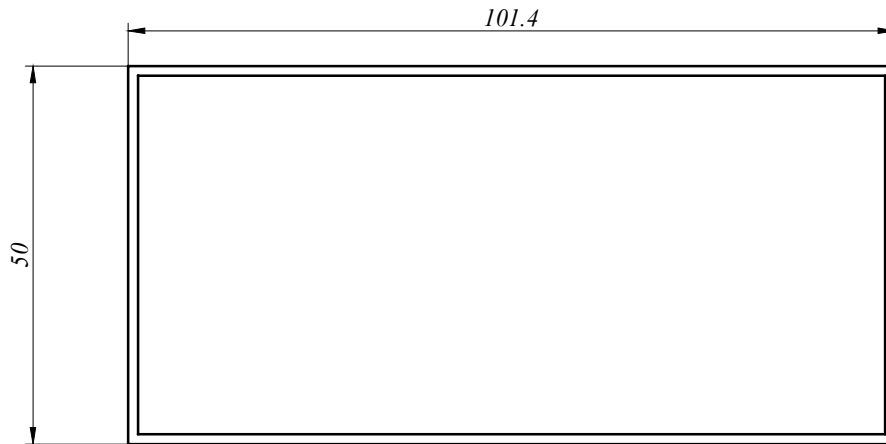

RH 23163225
2.043 Kg/M
AP : 302.800 MM

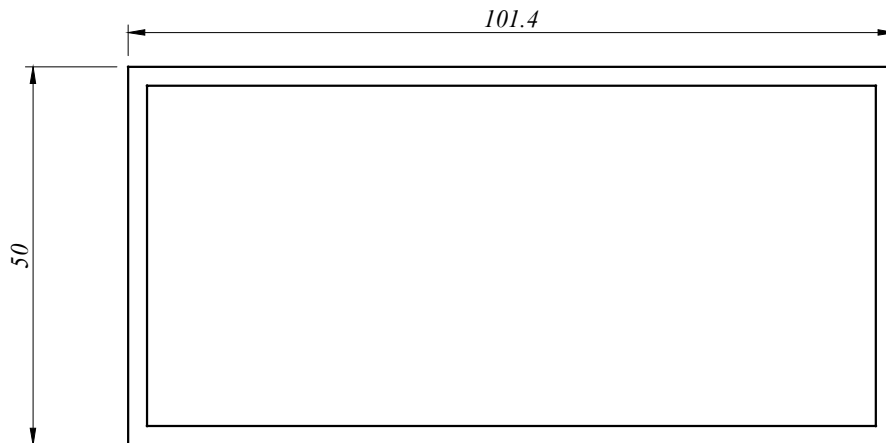

BP Aluminium Extrusion Sdn. Bhd.

No.15 & 16, 1C KKIP Selatan, Industrial Zone 2, KKIP,
88450, Jalan Sepanggar, Menggatal.



b_p_a_e@yahoo.com



www.bpaluminium.com